



SmartWash Seats

- The voltage required for this product should be in between 220 V - 240 V, 50 Hz - 60 Hz
- For your safety and proper use of the product, please read this user manual before using the seat
- The Warranty Card is included in this manual
- Online registration for warranty activation is a must. Please visit www.smartwash.world for more information
- Check for complete warranty clause on www.smartwash.world/warranty

SmartWash

Experience innovation at its best.

A complete solution.

One that is smart, hands-free,
and most importantly, blissful.

Feel the difference,
and perfect satisfaction,
in using this beautiful technology.

With advanced features
and diverse functions,
this superior product is,
'Designed for Pleasure'.

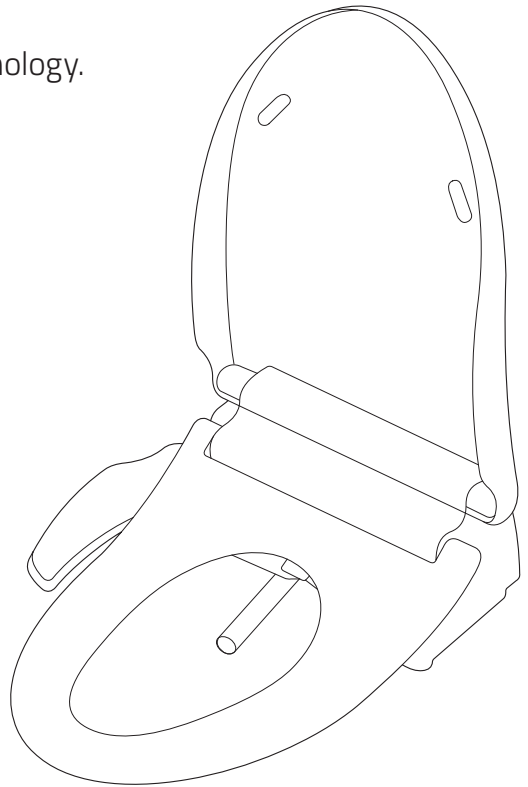

Contents

• Safety Precautions	4
• The Main Unit	6
• Choosing the Right Seat	8
• Accessories	10
• Functions of the Remote Control & Control Panel	12
• Installation Process	17
• How to Install the Remote Holder	20
• How to Use Basic Functions	21
• How to Uninstall the Seat	23
• Manual Cleaning and Maintenance	24
• Troubleshooting	25
• Self-Diagnosis	26
• Product Specifications	27
• Product Features	29
• Terms and Conditions	31
• SmartWash Warranty Card	35

Safety Precautions



Caution: It is advisable to follow the below precautions carefully, for your safety.

- Do not cover the rear air vent. It may cause burns or a fire.
- Ensure that the product does not get wet when cleaning. It may cause a short circuit or a fire.
- Unplug the seat if there is a beeping sound or a weird odour.
- Do not forcefully close the seat or the lid of the product. It may get damaged.
- Do not press the buttons too hard. The control panel may get damaged.
- Unplug the seat during a long absence.
- Do not drop water on the remote control and control panel. It may cause malfunction.
- Do not use a damaged power cord or plug, or a loose outlet.
- Please connect the power plug to a dedicated grounded electrical outlet.
- Do not lift the unit by its power cord.
- Do not touch the power plug with wet hands.
- Do not plug and unplug the power cord repeatedly.
- If the electric outlet is wet, carefully unplug the unit and let the outlet dry completely before subsequent use.
- Unplug the seat before repair, inspection, or parts replacement.
- Remove any dust or water off the power plug before inserting.
- Do not plug the seat into an outlet that is being used by several other appliances. It is preferable to use a dedicated outlet.
- Do not operate the seat if it has a damaged power cord or plug, if it is not working properly, or if it has been dropped, damaged or dropped into water.
- In case the power cord is damaged, do not replace the cord yourself. Call our service center to have it replaced.
- Do not insert a wire or sharp object in any of the gaps in the product or the dryer outlet.
- Do not place an electric heater near the product or dispose of any inflammable material such as a lit cigarette, in the toilet.
- Do not place any containers with water, medicine, food, small metallic objects, or any flammable material on top of the product.

- Do not disassemble, repair, or modify the product without exercising discretion.
- Close supervision is necessary when this seat is used by children, the elderly or disabled. Make sure to adjust the temperature of the toilet seat for anyone with sensitive skin.
- Use the seat only for its intended purpose as described in this manual. Do not use attachments not recommended by the manufacturer.
- Only authorized people can install or repair the seat. Do not attempt to repair this seat by yourself. Doing so could void the warranty.
- Keep the power cord away from heated surfaces.
- Do not drop or insert objects into any openings or hoses.
- Being seated on a heated seat for a long time may cause minor skin irritation. Be aware if the seat is being used by the following: a) Children, the elderly, patients, or those who cannot control the temperature settings b) Sleeping pill users or people who are on medication that cause drowsiness c) Who are intoxicated or tired and may fall asleep while sitting on the unit. If the seat causes minor skin irritation, consult a doctor immediately.
- Ensure that users do not insert their fingers in the gap between the lid cover and the rear end of the seat while opening/closing. This may cause minor injuries.
- This seat can be used by children aged 7 and up with adult supervision.
- This product must be used in a bathroom setting only. Do not use the product for other purposes that are not specified in the user manual.
- Do not pull out the mainline hose or the connection hose severely. This may damage to the product.
- Do not install the product near a heating device.
- Avoid installing the product in places where the air is damp, dusty or moist.
- Do not place or use inflammable gases or flammable materials near the product.
- Do not use the seat's control panel as a support or forcefully press it down. This may damage the product.
- **Do not stand and urinate. It should only be done while seated, so as to not splash on the seat and cause damage. This is for your hygiene.**

The Main Unit

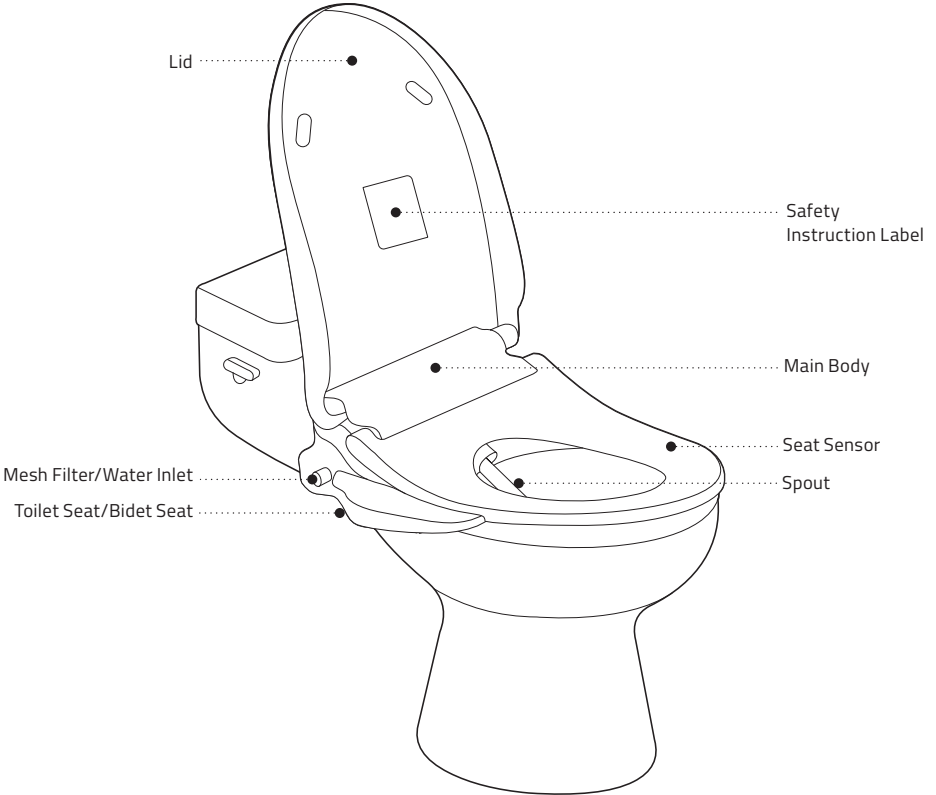

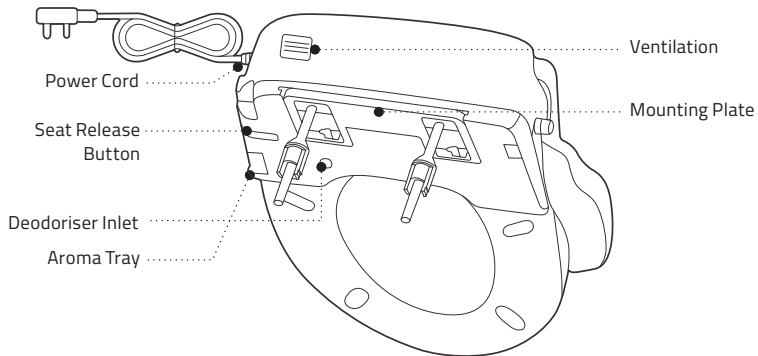

Basic Operating Panel**

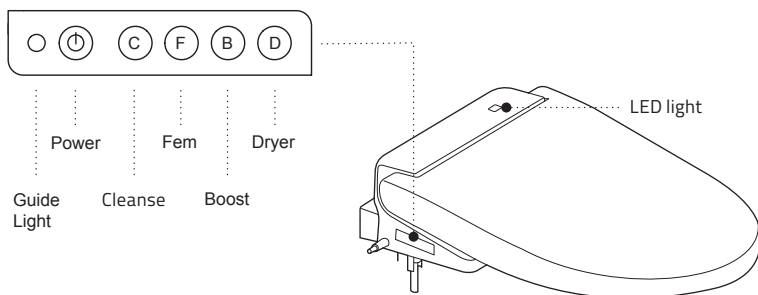

*Some of the features shown above may not be included in your model.

** Available only in Smartwash Bliss, Utopia and Carbon.

Choosing the Right Seat

Dimensions

The seat dimensions must be within those shown below. Do not install this product on a toilet that does not meet these dimensional requirements.

Circular Seat

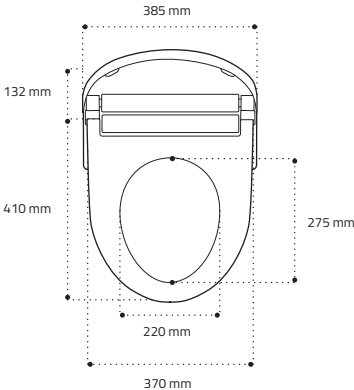

Elongated Seat

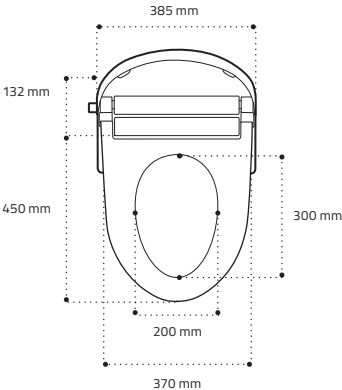

Rectangular Seat

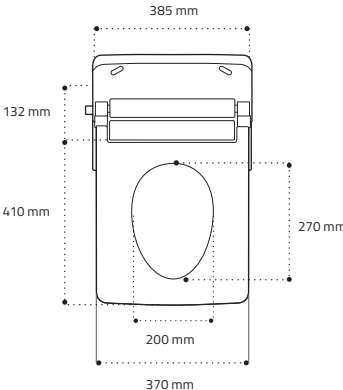

Distance of Fixing Holes

Ensure that your toilet seat has holes anywhere between the below dimensions, to be able to fix the seat correctly.

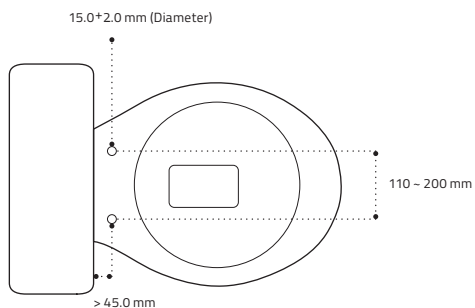

A flat surface area is required for fixing the seat perfectly. If your toilet has a curved surface area (as shown below) you may not be able to fix the seat properly.**

Bad



Good



** To know more about the compatibility of your model, please refer to the style guide section (under the 'Product' tab) on the website - www.smartwash.world

Accessories*

1. Mounting Bracket

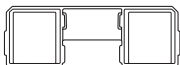

2. Mounting Plate

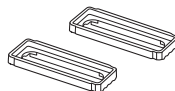

3. Mounting Bolt



4. Mounting Nut



5. Rubber Bush



6. Rubber Washer



7. Inline Water Filter



8. Branch Fitting



9. Flush Tank Hose



10. Aroma Cake



11. De-Odour Catalyst

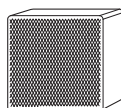

12. Main Water Hose



*These are additional accessories. Some of them may not be included in your model.

13. "AA" Size Alkaline Battery



15. Remote Holder



17. Rubber Pad Seat

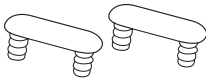

19. Child Seat

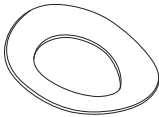

14. Anchor Plug and Screw

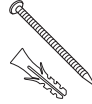

16. Rubber Pad Seat Cover

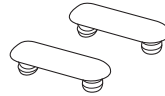

18. Auto Flush Valve

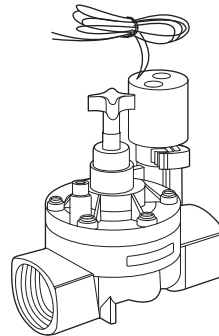

*These are additional accessories. Some of them may not be included in your model.

Functions of the Remote Control & Control Panel

The Remote Control and Control Panel are highly integrated smart systems that provide complete comfort and cleaning. The design is user-friendly and intuitive. It comprises large buttons and easy to understand icons for control of all functions and features.

The seat has a built-in sensor. This sensor is triggered on human body contact and is completely safe for the user. The seat functions can be operated once the sensor registers a person sitting down on the seat.

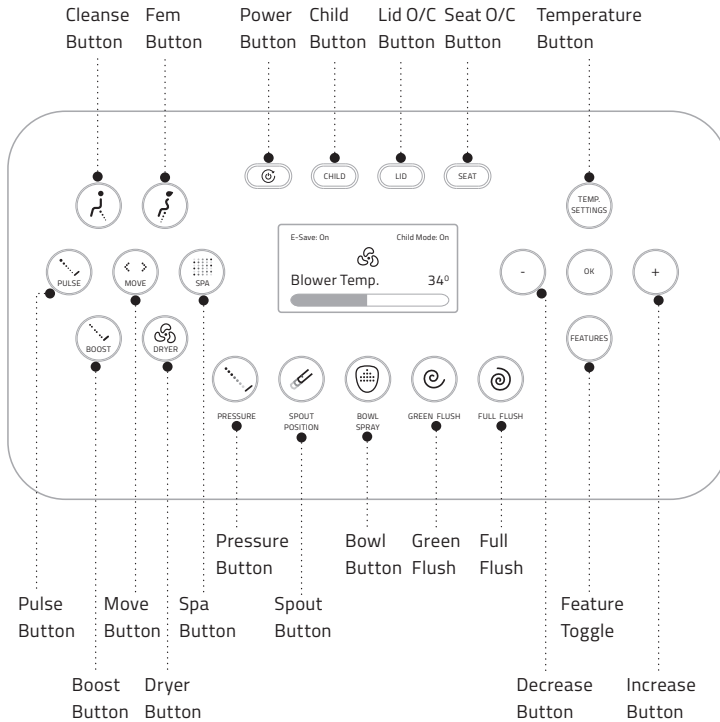

**Display shown here is indicative. Actual display may vary based on user interface.

*Some of these features may not be included in your model.

Sensa Control Panel

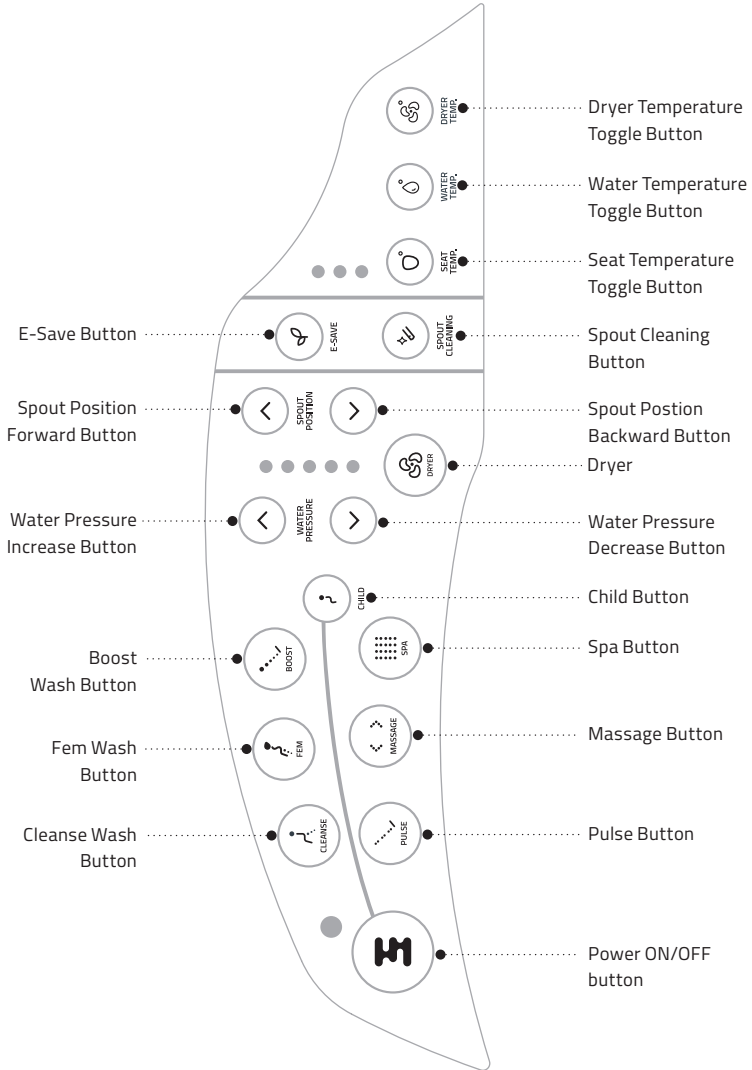

*Some of these features may not be included in your model.

Elate Control Panel

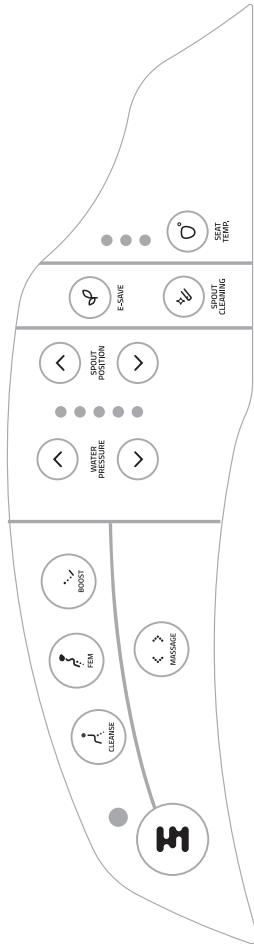

Ease Control Panel

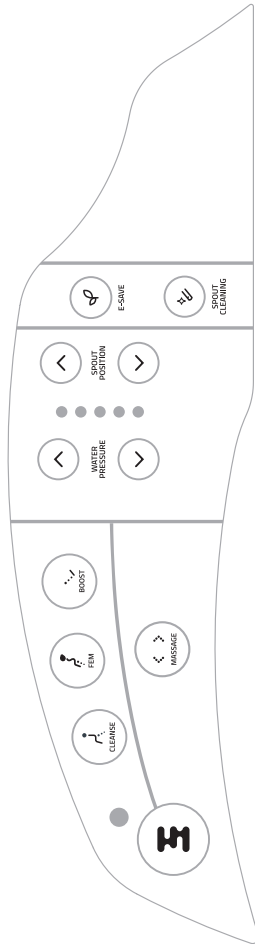

*Some of these features may not be included in your model.



Power: By pressing the SmartWash logo on the panel/remote, the seat powers on/off.



Cleanse: This function provides hands-free washing for the rear.



Pulse: This function provides a pulsating wash cycle for efficient cleansing and stimulating the wash area.



Fem: This function provides hands-free frontal washing for women.



Massage: This function enables the spout to move to and fro, to provide a massaging effect, using water.



Boost: This function increases the water pressure to full, for quick cleaning.



Spa: This feature is a combination of the Massage and Pulse functions along with a warm seat and warm water.



Child: This feature is integrated with Cleanse, Fem and Boost and will take care of all functional safety required for children.



Water Pressure: This function helps adjust the water pressure from the spout, if the user needs to change the pre-defined water pressure.



Dryer: This function activates the dryer fan.



Spout Position: This function helps adjust the spout position, if the user needs to change its pre-defined position.



E-Save: This function can be opted for to save electricity. It turns off the heating and puts the seat on sleep mode when not in use.

*Some of these features may not be included in your model.
Please check the 'Product Features' section to know more.



Spout Cleaning: This function is for cleaning the spout when the seat is not in use.



Seat Temperature: This function helps adjust the temperature of the seat. The seat has an in-built heating coil below the seat, to provide controlled warmth for comfortable seating.



Water Temperature: This function helps adjust the temperature of water. The seat has an in-built instant water heater, to provide controlled warmth for comfortable cleaning.



Dryer Temperature: This function helps adjust the dryer's temperature. Users can set the dryer temperature by toggling between the 3 options provided, low—mid—high.



Seat O/C: This function opens/closes the seat automatically.



Lid O/C: This function opens/closes the lid of the seat automatically.



Bowl Spray: This function activates a small water jet to spray the bowl. It is to be used before using the toilet.



Flush: This function flushes the toilet.



Green Flush: This function uses half the amount of water to flush, as compared to the full flush.



Camo-Sound: This function plays an audio to camouflage any sound when the toilet is in use.



Aroma: This function releases a pleasant fragrance into the air.



De-Odour: This function eliminates unpleasant odours present inside the toilet bowl and purifies the air. This does not add any additional fragrance.

*Some of these features may not be included in your model.
Please check the 'Product Features' section to know more.

Installation Process

Before Installing

1. Remove the bolts and detach the existing toilet seat and lid.
2. Turn off the water supply valve and detach the hose.

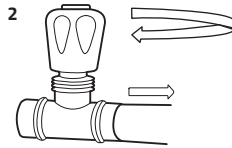

How to Install the Seat

3. Place the plate and guides over each mounting hole. Insert the mounting bolts with respect to the sequence shown in the picture.
4. Slide the seat into the mounting plate, until it clicks into place.
5. Once the seat position is acceptable for the user, tighten the bolts firmly.

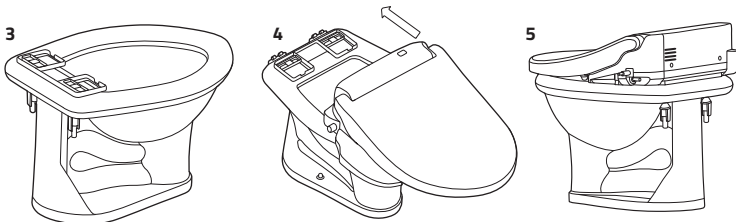
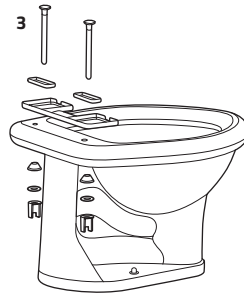

*Ensure that all the fixtures are tightened firmly.

**There may be some water left over in the product due to the test and inspection process at the factory.

How to Install the Plumbing

6. Detach the existing pipe from the water outlet.
7. The branch fitting has three outlets. Attach one side of the branch fitting to the water outlet.
8. Attach the second outlet of the branch fitting to the water filter.
9. Attach the filter to the main water line hose on the other end. Connect this hose to the seat inlet.
10. Attach the flush hose to the third outlet (middle outlet) of the branch fitting and connect it to the flush tank.
11. Open main valve for water supply.
12. Connect the power plug to the electrical outlet. Make sure to use a grounded outlet.

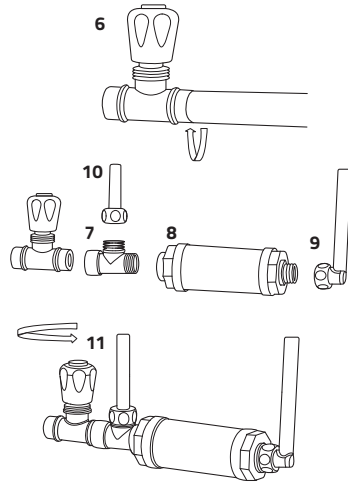

How to Install the Auto Flush Valve*

13. Fix a one inch male threaded nipple (not in the list of accessories provided) into the water line inlet and outlet.
14. Connect the Auto Flush valve to the water line.
15. Place the Auto-Flush valve on the wall or conceal it inside the wall.

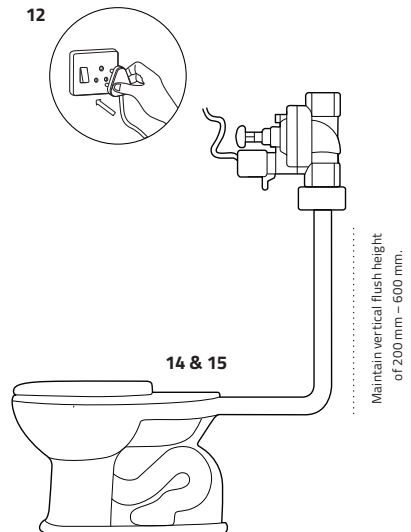

*This feature is only available with the SmartWash Utopia and SmartWash Carbon seats.

Auto Flush Valve

During power failures, use the Manual Override option. Turn back the manual override knob to home position, to enable the automatic operation again.

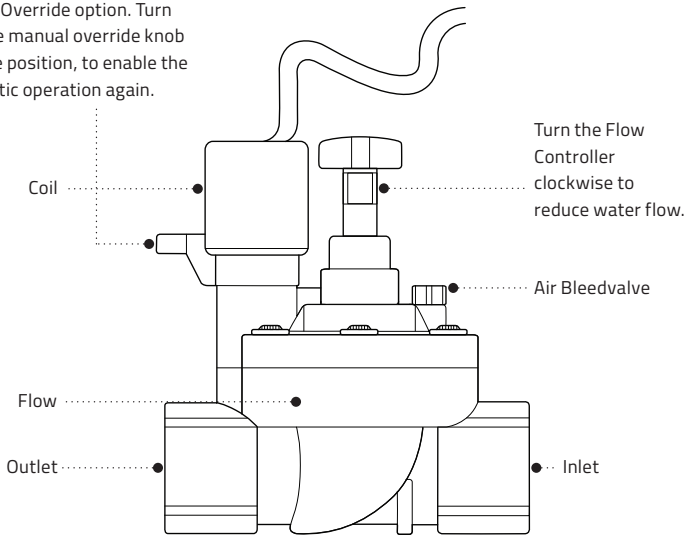

16. Connect the DC Jack to the outlet available in the product.

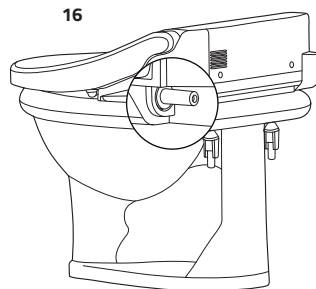

How to Install the Remote Holder

1. Attach the remote holder on the wall using the anchor plugs and tighten with screws.

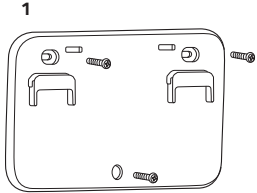

2. Slide the remote downwards on the holder to lock.

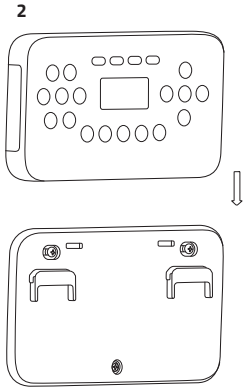

How to Use Basic Functions



Cleanse and Fem Wash



- Sit and press the 'Cleanse' button on the remote control/panel. The spout will spray room temperature water to the rear end. For front washing, female users can press the 'Fem' button.
- While washing, users can adjust the water temperature, water pressure, seat temperature and spout position according to their preference.
- The water sprays for two minutes and then automatically stops. Users can also stop it before two minutes, by pressing the Power button.
- If the 'Pulse' feature is selected when the Cleanse/Fem is in operation, a pulsating action gets activated.
- The spout gets cleaned automatically before and after every use. This may take up to five seconds.



Boost

- Press the 'Boost' button on the remote control/panel.
- The spout increases water pressure to full, for quick cleaning.
- This function works upto 2 minutes.



Massage

- Press the 'Massage' button on the remote control/panel.
- The spout moves back and forth, providing a wider range for washing.
- To stop the function, press the 'Massage' button again.

*Some of these features may not be included in your model.
Please check the 'Product Features' section to know more.



Dryer

- Press the 'Dryer' button on the remote control/panel.
- Warm air blows for about two minutes to dry.
- Adjust the dryer temperature by pressing the 'Dryer Temp.' button.



Child

- Press the 'Child' button on the remote control/panel to make the seat automatically go into child safety mode.
- Temperature functions will become low.
- Press Cleanse or Fem as per the user's preference.
- The spout moves forward for easy cleaning of the child.



E-Save

- Press the 'E-Save' button on the remote control/panel.
- All the LED lights will turn off.
- This function will help save electricity.

*Some of these features may not be included in your model.
Please check the 'Product Features' section to know more.

How to Uninstall the Seat

1. Unplug the seat from main power outlet.

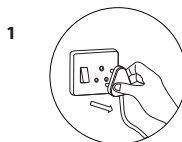

2. Turn off the main water supply valve.
3. Drain any remaining water from the water line.

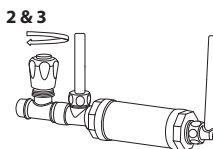

4. Slide the seat from the mounting plate by pressing the seat release knob.

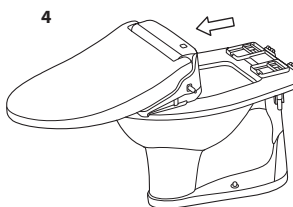
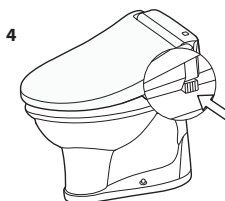

5. Remove the mounting bolts and lift the mounting plate.

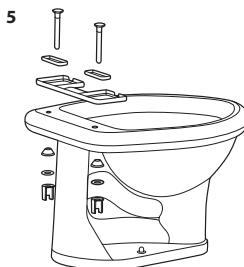

Manual Cleaning and Maintenance

Seat Cleaning

Use soft sponges and neutral detergents when wiping the seat.



Spout Cleaning

To clean the spout, press the 'Spout Cleaning' button. The spout comes out for 2 minutes, before returning to its original position. During this operation, the spout will spray water in a low pressure for easy cleaning. It is recommended to clean the spout at least once every month.

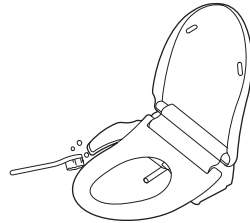

Mesh Filter Cleaning

To clean the mesh filter, disconnect the water line hose from the seat inlet. A small mesh will be visible. Clean this mesh using a soft cloth/brush.

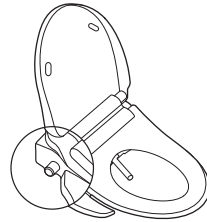

Aroma Cake Replacement

Open the aroma tray and replace the fragrance cake. Make sure to fit it back in the allotted space. It is recommended to replace the cake once in every 15 days.

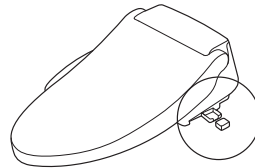

Inline Water Filter Replacement

Turn off the water supply valve. Disconnect the hose to replace the filter with a new one. It is recommended to replace the filter once in 4-6 months, based on the frequency of usage.

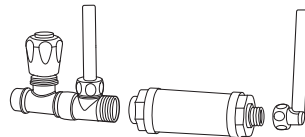

Troubleshooting

Problem	Indication
The seat is not functioning	<ul style="list-style-type: none">• Main connection; socket and plug• Power button in user interface panel• Power failure
The spout is not spraying water	<ul style="list-style-type: none">• Main water supply• Spout, for any foreign particle or blockage• Clean mesh filter at water inlet connection of the product by removing the hose
The water pressure is low	<ul style="list-style-type: none">• Water pressure setting• Blockage in the spout or mesh filter
Seat is not warm; water is not warm; air is not warm	<ul style="list-style-type: none">• Relevant temperature settings on the remote control/panel• Electricity
A strange noise is coming from the seat	<ul style="list-style-type: none">• It is normal to hear some noise. The noise level will vary based on various operations
Water is leaking from the product	<ul style="list-style-type: none">• The water drain provision is provided near the spout to remove excess water during cleaning. It is not a malfunction

Self-Diagnosis

Symptom	Things to Check
The spout is not spraying water	A buzzer and a red LED light in the panel will start blinking
Seat is not heating up	A continuous buzzer and temperature indicator LED light in the panel will start blinking
Water is not heating up	A continuous buzzer and temperature + pressure indicator LED light in the panel will start blinking
Dryer is not blowing warm air	A continuous buzzer and temperature + pressure indicator LED light in the panel will start blinking

Product Specifications

Description		Specifications					
		Ease	Elate	Sensa	Bliss	Utopia	Carbon
Rated Voltage		AC 220 V ~ 240 V, 50 Hz					
Max Power Consumption		35 W	90 W	1500 W	1500 W	1500 W	1500 W
Power Cord Length		1.8 mts					
Water Supply Method		Directly Connected to the Water Pipe					
Cleaning Function	Water Volume	Cleanse	0.36 to 1.08 L/min @ water pressure 0.02 MPa				
		Fem	0.36 to 1.08 L/min @ water pressure 0.02 MPa				
		Child	NA	NA	0.36 to 0.84 L/min @ water pressure 0.02 MPa		
		Boost	0.82 to 1.08 L/min @ water pressure 0.02 MPa				
	Water Temp	NA	NA	34°/37°/40°C			
	Heater Capacity	NA	NA	1500 W			
	Safety Device	NA	NA	Bimetal			
	Back Flow Prevention Device	Inbuilt Check Valve					
	Temperature Control	NA	NA	Bimetal			
	Seat	Surface Temperature	NA	34°/37°/40°C			
Heater Capacity		NA	55 W				
Safety Device		NA	Thermal Fuse				
Dryer	Air Flow	NA	NA	0.24 to 0.28 m ³ /min			
	Heater Capacity	NA	NA	300 W			
	Safety Device	NA	NA	Thermal Fuse			

Description		Specifications					
		Ease	Elate	Sensa	Bliss	Utopia	Carbon
Deodorizer	Method	NA	NA	NA	o ₂ deodorizing		
	Air Flow	NA	NA	NA	0.128 to 0.143 m ³ /min		
	Power Consumption	NA	NA	NA	2.16 W		
Water Supply Pressure		0.07 to 0.75 Mpa					
Feed Water Temperature		0 - 35°C					
Ambient Temperature		0 - 40°C					
Product Safety for High Voltage and Current		Inbuilt MOV and Fuse					
Product Dimension (mm)	Circular	385 (W) x 130 (H) x 505 (L)					
	Elongated	385 (W) x 130 (H) x 545 (L)					
	Rectangular	385 (W) x 130 (H) x 520 (L)					
Product Weight (kg)	Circular	3.8	4	4.2	4.5		
	Elongated	4	4.2	4.4	4.7		
	Rectangular	4.5	4.7	4.9	5.2		

Product Features

	Function	Ease	Elate	Sensa	Bliss	Utopia	Carbon
Wash / Dry / Fragrance Functions	SmartWash - ON/OFF	✓	✓	✓	✓	✓	✓
	Cleanse	✓	✓	✓	✓	✓	✓
	Fem	✓	✓	✓	✓	✓	✓
	Child	✗	✗	✓	✓	✓	✓
	Dryer	✗	✗	✓	✓	✓	✓
	De-Odour	✗	✗	✗	✓	✓	✓
	Aroma	✗	✗	✗	✓	✓	✓
Essential Functions	E-Save	✓	✓	✓	✓	✓	✓
	Massage	✓	✓	✓	✓	✓	✓
	Boost	✓	✓	✓	✓	✓	✓
	Pulse	✗	✗	✓	✓	✓	✓
	Seat Sensor	✓	✓	✓	✓	✓	✓
	Spa	✗	✗	✓	✓	✓	✓
	Spout Cleaning - Manual	✓	✓	✓	✓	✓	✓
	Spout Cleaning - Auto	✓	✓	✓	✓	✓	✓
	Spout Adjustment - As per need from Home to Work Position	✓	✓	✓	✓	✓	✓
	Water Pressure - 5 Set Points	✓	✓	✓	✓	✓	✓
Safety Functions	Self Check while Power ON	✓	✓	✓	✓	✓	✓
	Self-Diagnosis	✓	✓	✓	✓	✓	✓
	Battery Life Indication	✗	✗	✗	✓	✓	✓
	Anti-Bacterial Coating	✓	✓	✓	✓	✓	✓
Comfort Functions	Warm Seat	✗	✓	✓	✓	✓	✓
	Water Heating	✗	✗	✓	✓	✓	✓
	Automatic Seat Closing	✗	✗	✗	✓	✓	✓
	Automatic Lid Closing	✗	✗	✗	✓	✓	✓

	Function	Ease	Elate	Sensa	Bliss	Utopia	Carbon
	Remote	✗	✗	✗	✓	✓	✓
	Seat Soft Closing	✓	✓	✓	✓	✓	✓
	Lid Soft Closing	✓	✓	✓	✓	✓	✓
Advanced Functions	Wi-Fi	✗	✗	✗	✓	✓	✓
	Carbon Foot Print	✗	✗	✗	✗	✗	✓
Add-Ons	Bowl Spray	✗	✗	✗	✓	✓	✓
	Auto Flush	✗	✗	✗	✗	✓	✓
	Green Flush	✗	✗	✗	✗	✓	✓
	Camo-Sound - Running Water	✗	✗	✗	✓	✓	✓
	Guide Light	✗	✗	✗	✓	✓	✓
	Commode	✗	✗	✗	✗	✓	✓
Optional Add-Ons	Artwork	✓	✓	✓	✓	✓	✓
	Child Seat	✗	✗	✓	✓	✓	✓
	In-line Water Filter	✓	✓	✓	✓	✓	✓

Terms and Conditions

1. These Terms and Conditions will apply to the purchase of the goods along with the spare parts detailed in our Invoice (hereinafter referred to as "the Product/s") by the buyer ("you") from Dr. Wiesner Test & Automation.

The following warranties replace all other warranties and liabilities, whether oral, written, (non-mandatory) statutory, contractual, in tort or otherwise, including, without limitation, and where permitted by applicable law, any implied conditions, warranties or other terms as to satisfactory quality of fitness for purpose and of any other warranty obligation on the part of seller.

A. Scope of Warranty

- i. We, except as otherwise hereinafter provided, warrants the Product against faulty workmanship or the use of defective materials and that such Products will conform to the written specifications, drawings, and other descriptions for a period set forth in the sub-clause (ii) below.
- ii. We warrant that at the time of delivery, we have the title to the Product free and clear of any and all liens and encumbrances, subject to you paying the full Purchase Price.
- iii. We, at our decision, pursuant to its obligations under the Warranty:
 - a. Repair or replace the defective Product or part;
 - b. Pay the cost of repairing the defective product or part at our discretion;
 - c. Refund the purchase price to the purchaser/you
 - d. Make appropriate adjustment
- iv. These warranties at iii (a), (b) & (c) above are the only warranties made by us and can be validly amended only by us, via a written instrument signed by one of the authorized officers.
- vi. The Warranty applies only within India and only to the original purchaser.

B. The Purchaser shall be responsible for and shall meet all charges in respect of making the defective product accessible for repair or replacement.

C. Use of Cleaners: Use of chemicals such as bleach, hair dye, solvents, alcohol, citrus based chemicals, or abrasive cleaners on any part of the Product will void the warranty.

D. Warranty Period

The warranty period offered by us will be as specified in your Purchase Order. Unless agreed upon otherwise by us, in writing, the Warranty period shall expire 12 months after delivery of the Product.

e. Notification of a Defect

You shall inform us in writing or in any other method notified by us, of any defect in the Product noticed during the warranty period not later than two weeks from first noticing the same. On receipt of your notice, we or any third party entrusted by us shall rectify the faults. The option to repair or replace any parts shall solely rest with us. You shall not return the Products or any part thereof to us before receiving our confirmation, in writing, to that effect.

You shall inform us within 15 (Fifteen) days on receiving the Product of any defects in the Product. You shall not be entitled to any warranty in the event of your failure to inform us within the stipulated time line.

f. Exclusion of Warranty

- i. If the Product is not purchased from us or our authorized Sales Dealers.
- ii. If the Product purchased is not installed, maintained or used according to instructions given in the User/Instruction Manual or determined by our personnel.
- iii. If the Warranty Card is not filled and mailed back/submitted to us or our Authorized Service Centre within 2 weeks of purchase or not registered with on our website as specified in the User Manual.
- iv. The Product is being used for commercial use/purpose or in any place which in our determination can be construed as commercial usage.
- v. The site (premises where the Product is kept/used) conditions do not conform to the recommended operations of the Product/unit.
- vi. The original Serial Number is removed, obliterated or altered from the Product.
- vii. Defects due to causes beyond control such as lightning abnormal voltage, acts of god or while in transit to the Service Centre or to the Purchaser's residence.
- viii. Defects caused by household pets, rats, rodents, insects etc.
- ix. Any damage to the Product caused due to improper use, due to accident, improper installation or handling, improper care and cleaning, alteration, abuse, misuse, faulty repairs, usage etc, as determined by our personnel.
- x. We shall not be responsible for any defect or damage caused due to any alterations, addition, or repair carried out to the Products by any person not authorized by us to carry out such alterations, addition or repair.
- xi. We shall not be responsible for any defect or damage caused to the Product, directly or indirectly, due to mishandling, misuse of the Product, misconduct or negligence on your part or your agents to operate the Product as recommended by us in the User Manual, a copy of which shall be provided with each unit.
- xii. Parts which deteriorate due to wear and tear, consumables or any such parts not specifically covered under this warranty shall be outside the scope of this warranty.

xiii. The items not manufactured by us or any of its affiliates/sister concerns will not be covered under the scope of this warranty, unless otherwise specifically mentioned.

6. Post Warranty Service

Post warranty service will be made available through Bengaluru and its decentralize service engineers stationed all over India. Our Head Office address is:

Dr. Wiesner Test & Automation Pvt. Ltd (DRWTAPL),
#147, 6th Main, 3rd Cross, Industrial Suburb,
2nd Stage, Yeshwanthpur Industrial Layout,
Near Tumkur Road, Bengaluru – 560 022

7. The logo/image/word mark of “SmartWash” is our Trademark and cannot be used or communicated or distributed without our specific and written permission. By virtue of purchasing our Product, you understand and agree that you have no kind of ownership or title or claim over our trademarks either registered or otherwise.
8. To the extent permitted by applicable law, the aggregate liability on us arising under these terms & conditions and/or contract for the purchase of Products shall be limited to the purchase value of the Product or the insurance cover taken by us, if any, to cover the claim/damage which has occurred, whichever is lower.

9. Products Colour

All Products exhibited on our brochures, website and other sales documentation are on an “as is” and “as available” basis. Images and the colour of products are for and by reference only and the actual Product and colour may vary from the corresponding image exhibited. We disclaim any liabilities arising out of any discrepancies to this end.

10. Intellectual Property Rights

- a. You shall only have the right to use the software, technical know-how, operating instructions, product brochures/data sheet and any other proprietary information supplied. The ownership of such items shall clearly vest and remain with us. You shall not violate breach or infringe the said rights in any manner whatsoever.
- b. You shall indemnify, defend, and hold us as well as our affiliates/Contract Manufacturers harmless against all claims, demands, and expenses, including but not limited to legal fees, arising from our manufacture and supply of the Products to you, whether for breach or damage to any intellectual property rights or other proprietary rights of any third party.

11. Relationship between the Parties

It is expressly agreed that all transactions between us shall be on principal-to-principal basis and that nothing hereunder or in the order shall constitute or be deemed constitute either party as the agent or employee or hirer or laborer of the other.

12. Governing Law and Arbitration

- a. This Agreement shall be governed by the laws of India, and the courts of Bengaluru shall have the jurisdiction to try and disputes arising hereunder.

b. Any dispute or difference or claim arising out of or in relation to this transaction including construction, validity performance or breach thereof shall, failing amicable settlement be referred to a sole arbitrator under The Arbitration Centre- Karnataka presently located at Khanija Bhavan, Race Course Road, Bengaluru-560001 and the Rules set out by them and any subsequent amendments thereof for time being in force. Such arbitration shall take place in Bengaluru, and the arbitration proceedings shall be conducted in the English language. Award of arbitration shall be final and binding on parties and shall be enforceable in any court of law.

13. Legal Construction

The contract shall be construed and operated as Indian/contract and in conformity with Indian Law. All correspondence & commitments between us and you, to be enforceable at law, shall be in writing.

14. Notice

Any notice required or permitted hereunder shall be in writing and shall be deemed duly served upon receipt, when delivered personally or by a delivery service of 72 (seventy-two) hours after being deposited in the mail as certified or registered mail with postage prepaid. Notices shall be addressed to the address provided in the Purchase Order or provided by you in writing.

SmartWash Warranty Card

Dear SmartWash Customer,

Please retain this warranty card carefully. Attach your purchase receipt to this warranty card. This warranty will be valid only after registering the product online. You must produce both, the warranty card and the proof of purchase in the event of a repair.

Customer Details:

Name:

Address:

Pincode: Contact No.:

Email:

Product Details:

SmartWash Model:

Serial No.:

Purchased From:

Online | DSA | Dealer | Distributor | Others

Name:

Address:

Pincode:

Contact No.:

Purchased On:

Purchase Date:

Invoice No.:

Note:

- This warranty is valid for 1 year from the date of purchase.
- This warranty is valid only after registering the product online.
- This warranty is non-transferable.
- This warranty will be void, if the product is subjected to unauthorised repair or damage due to impact.
- Erasure, alteration or defacement of this form invalidates the warranty.



BALLAMUDI
TECHNOLOGIES

Registered Office:

#444, KIADB, 2nd Stage, Sompura Industrial Area,
Dabaspet, Bengaluru, Karnataka 562111
www.ballamudi.in

mail : info@ballamudi.in

Call : +91 8150952266 / +91 8150852266